

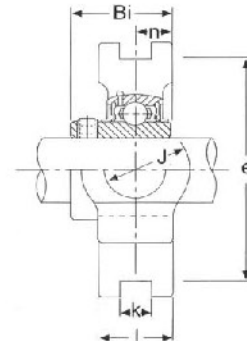

## All Stainless Steel Take-Up Units

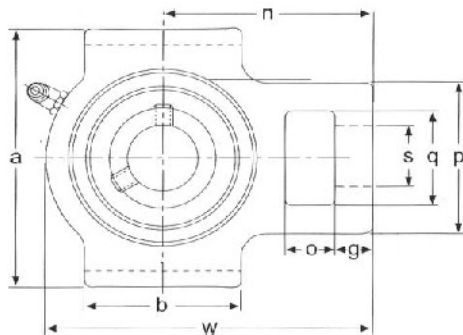

**Dimension table . Dimensions in mm**

Unit No.	Shaft Dia		o	g	p	q	s	b	k	e	a	w	J	l	h	Bi	n	Bolt Size mm	Bearing No.	Housing No.	Weight kg
	d (in)	d (mm)																			
MUCT 204-12 MUCT 204	3/4	20	16	10	51	32	19	51	12	76	89	94	32	21	61	31	12.7	M10	SUC 204-12 SUC 204	ST204	0.828
MUCT 205-14 MUCT 205-15 MUCT 205	7/8 15/16	25	16	10	51	32	19	51	12	76	89	97	32	24	62	34	14.3	M10	SUC 205-14 SUC 205-15 SUC 205	ST205	0.892
MUCT 205-16	1																				
MUCT 206-17 MUCT 206-18 MUCT 206	1-11/16 1-1/8	30	16	10	56	37	22	57	12	89	102	113	37	28	70	38	15.9	M14	SUC 206-17 SUC 206-18 SUC 206	ST206	1.324
MUCT 206-19 MUCT 206-20	1-3/16 1-1/4																				
MUCT 207-20 MUCT 207-21 MUCT 207-22 MUCT 207	1-1/4 1-5/16 1-3/8	35	16	13	64	37	22	64	12	89	102	129	37	30	78	42	17.5	M14	SUC 207-20 SUC 207-21 SUC 207-22 SUC 207	ST207	1.772
MUCT 207-23	1-7/16																				
MUCT 208-24 MUCT 208-25 MUCT 208	1-1/2 1-9/16	40	19	16	83	37	22	83	16	102	114	144	49	33	88	49	19	M14	SUC 208-24 SUC 208-25 SUC08	ST208	2.578
MUCT 209-26 MUCT 209-27 MUCT 209-28 MUCT 209	1-5/8 1-11/16 1-3/4	45	19	16	83	39	29	83	16	114	117	144	49	35	87	49	19	M14	SUC 209-26 SUC 209-27 SUC 209-28 SUC 209	ST 209	2.658
MUCT 210-30 MUCT 210-31 MUCT 210 MUCT 210-32	1-7/8 1-15/16	50	19	16	83	49	29	86	16	117	117	149	49	37	90	52	19	M16	SUC 210-30 SUC 210-31 SUC 210 SUC 210-32	ST210	2.765