

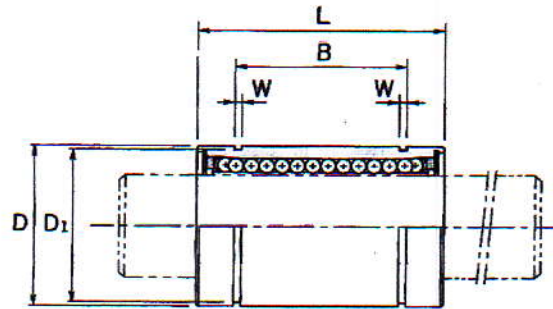

Linear Bushing



Dimension table . Dimension in mm

Cylindrical type		Weight g	Clearance adjustable type	Open type	Inscribed circle diameter dr Tolerance	Outer diameter D Tolerance	
Standard type	Number of ball rows						
LME 5	4	11	LME 5 AJ	-	5	12	0
LME 8	4	20	LME 8 AJ	-	8	16	-0.008
LME 12	4	41	LME 12 AJ	LME 12 OP	12	22	0
LME 16	4	57	LME 16 AJ	LME 16 OP	16	26	-0.009
LME 20	5	91	LME 20 AJ	LME 20 OP	20	32	0
LME 25	6	215	LME 25 AJ	LME 25 OP	25	40	0
LME 30	6	325	LME 30 AJ	LME 30 OP	30	47	-0.011
LME 40	6	705	LME 40 AJ	LME 40 OP	40	62	0
LME 50	6	1130	LME 50 AJ	LME 50 OP	50	75	-0.013
LME 60	6	2220	LME 60 AJ	LME 60 OP	60	90	0
LME 80	6	5140	LME 80 AJ	LME 80 OP	80	120	0
							-0.015

- Linear bushing with model no.50 or below, a synthetic resin retainer is built-in to reduce running noise.
For use at temperatures excess of 80oc, specify the letter 'GA' at the end of the model no. to install steel retainer.
- Specify when seal type is needed.

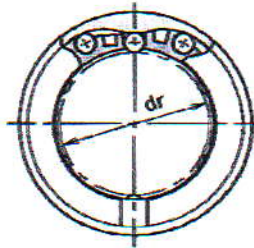

Type LME

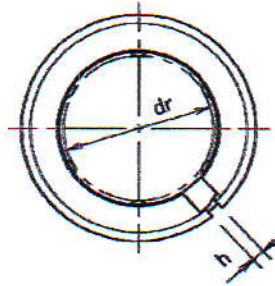

Type LME-AJ

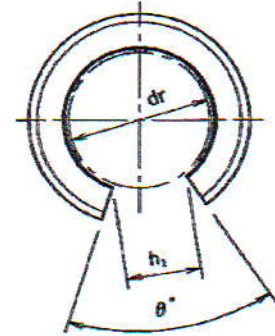

Type LME-OP

Dimension table . Dimension in mm .

Length									Eccentricity	Radial clearance tolerance	Basic load rating	
L	Tolerance	B	Tolerance	W	D1	h	h1	Ø	(Max.) m	m	C N	C ₀ N
22	0 -0.2	14.5	0 -0.2	1.1	11.5	1	-	-	12	-5	196	252
25		16.5		1.1	15.2	1	-	-	12	-5	252	382
32		22.9		1.3	21	1.5	7.5	78°	12	-7	485	736
36		24.9		1.3	24.9	1.5	10	78°	12	-7	549	847
45		31.5		1.6	30.3	2	10	60°	15	-9	820	1 301
58	0 -0.3	44.1	0 -0.3	1.85	37.5	2	12.5	60°	15	-9	931	1 491
68		52.1		1.85	44.5	2	12.5	50°	15	-9	1 491	2 612
80		60.6		2.15	59	3	16.8	50°	17	-13	2 052	3 819
100		77.6		2.65	72	3	21	50°	17	-13	3 629	7 543
125	0	101.7	0	3.15	86.5	3	27.2	54°	20	-16	4 474	9 500
165	-0.4	133.7	-0.4	4.15	116	3	36.3	54°	20	-16	6 982	15 200

- For steel type retainers, the form will be Linear bushing type as shown below.
- To prevent moment load, avoid using one linear bushing on a shaft but use two or more bushings, and the installation distance between the bushings should be made as large as possible.