

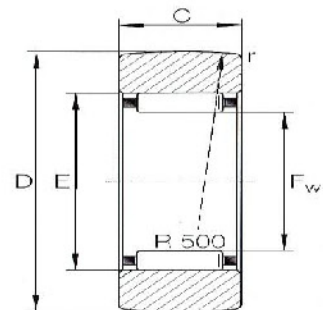

## Yoke type track rollers

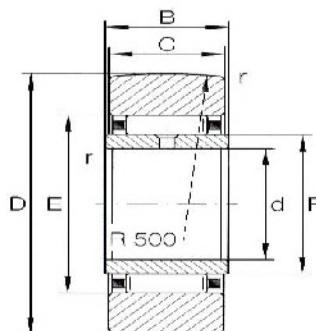

**Dimension table . Dimensions in mm**

Outside diameter	Without inner ring	Mass ≈ g	With inner ring	Mass ≈ g	Dimensions							Basic load rating		Fatigue limit load P <sub>UW</sub> N	Speed <sup>2)</sup> n <sub>D grease</sub> min <sup>-1</sup>
	Designation		Designation		D	d	F <sup>1)</sup> F <sub>w</sub>	B	C	E	r min.	dyn C <sub>w</sub> N	stat C <sub>ow</sub> N		
16	RSTO 5 TN	8.5	-	-	16	-	7	-	7.8	10	0.3	2 422	2 422	294	15 200
19	RSTO 6 TN	12.5	STO 6 TN	17	19	6	10	10	9.8	13	0.3	3 562	4 275	551	9 500
24	RSTO 8 TN	21	STO 8 TN	26	24	8	12	10	9.8	15	0.3	3 990	5 225	665	7 600
30	RSTO 10	42	STO 10	49	30	10	14	12	11.8	20	0.3	7 980	8 740	1 111	5 225
32	RSTO 12	49	STO 12	57	32	12	16	12	11.8	22	0.3	8 455	9 595	1 216	4 275
35	RSTO 15	50	STO 15	63	35	15	20	12	11.8	26	0.3	8 645	10 165	1 282	3 135
40	RSTO 17	88	STO 17	107	40	17	22	16	15.8	29	0.3	13 585	16 815	2 080	2 660
47	RSTO 20	130	STO 20	152	47	20	25	16	15.8	32	0.3	15 390	20 425	2 565	2 280
52	RSTO 25	150	STO 25	177	52	25	30	16	15.8	37	0.3	15 675	21 755	2 707	1 710
62	RSTO 30	255	STO 30	308	62	30	38	20	19.8	46	0.6	22 135	33 250	3 800	1 235
72	RSTO 35	375	STO 35	441	72	35	42	20	19.8	50	0.6	24 225	38 000	4 322	1 045
80	RSTO 40	420	STO 40	530	80	40	50	20	19.8	58	1.0	22 800	37 050	4 702	807
85	RSTO 45	453	STO 45	576	85	45	55	20	19.8	63	1.0	24 225	40 850	4 702	712
90	RSTO 50	481	STO 50	617	90	50	60	20	19.8	68	1.0	24 700	44 175	5 130	617

- TN = Plastic cage, permissible operating temperature: +120°C (continuous operation)

F = raceway diameter of the inner ring,

F<sub>w</sub> = needle enveloping circle with tolerance zone F6.